



2021 Facilities Master Plan Addendum

SBCCD Board of Trustees

Dr. Anne L. Viricel, Chair

Dr. Stephanie Houston, Vice Chair

Gloria Macías Harrison, Clerk

John Longville, Trustee

Joseph Williams, Trustee

Frank Reyes, Trustee

Dr. Donald L. Singer, Trustee

Alex Ramos Huaman, CHC Student Trustee

Adrian Rios, SBVC Student Trustee

CRAFTON HILLS COLLEGE

SAN BERNARDINO COMMUNITY COLLEGE DISTRICT

Crafton Hills College - Main Campus
11711 Sand Canyon Rd.
Yucaipa, CA 92399



Recommendations - Updated

The 2021 Facilities Master Plan Addendum updates the Recommendations, Section-3 of the 2017 Facilities Master Plan with some modifications to existing facilities recommended for demolition and new and renovated projects. These modifications are based on updated information, factors, and economic considerations that came to light as the measure CC bond implementation program developed. The first factor was recognizing that current cost estimates for the complete renovation of the existing Performing Arts Center to meet current code requirements would exceed over 50% of a new facility and per CAC 4-309 and Division of State Architect considerations, the facility must therefore be replaced rather than renovated. Demolishing the existing Performing Arts Center opens an opportunity to create a new instructional facility that could also include Visual Arts, integrating the Arts for exposure to all students on campus and creating robust student-focused activity and culture in the heart of the campus. Building a new instructional building in the center of the campus replaces the need to build an instructional building on the east campus, allowing this site to remain open for construction of another building adjacent to Canyon Hall later in the future. This would create a science focus hub on the East Quad.

The proposed location for the new Performing Arts Center allows the facility to be efficiently designed for current and future instructional needs and eliminates the need for challenging and expensive swing space during construction. The proposed location provides easy access and parking for performance spectators and a feature building at the entrance to the campus center.

The College also looked at operational efficiencies for renovations of existing space to maximize instructional space to support the Campus-wide Instructional Space Upgrades recommendation included in the 2017 Facilities Master Plan. Proposed modifications to the renovations in the 2021 Facilities Master Plan Addendum include larger active learning, flexible classrooms to promote student success and enhance efficiencies.

Any modifications to projects or content of the Recommendations Section 3 of the 2017 Facilities Master Plan in the 2021 Facilities Master Plan Addendum are noted as “UPDATED” in the project title.

The Needs, Section-2 of the 2017 Facilities Master Plan will be updated simultaneously with the Educational Master Plan later in the future.

Recommendations

RECOMMENDED DEMOLITION + REPLACEMENT - UPDATED

The graphic on the opposing page illustrates the recommendations for demolition and removal of facilities. Some temporary facilities, as well as aged permanent facilities that are no longer feasible or cost effective to renovate, are recommended for replacement. The decision to renovate or replace an existing facility is often influenced by the limitations that an existing structure, code requirements, or site places on the success of a potential renovation. These factors were considered by SBCCD and Crafton Hills College in seeking the most effective long term solutions for the campus.

The removal of the following facilities clears the way to improve the utilization of the campus land area and maximizes the use of resources. Removal of facilities will be phased to take place as new and renovated space becomes available.

Through discussions with Crafton College Council, the demolition of the existing Gymnasium has been deemed a high priority due to the Council's desire to end the expenditure of resources to maintain this structure.

Facilities to be Demolished and Removed

- › Gymnasium
- › PAC
- › Visual Arts
- › East Complex
- › North Complex - future



RECOMMENDED DEMOLITION & REMOVAL

PROPERTY LINE
EXISTING PERMANENT FACILITIES
FACILITIES IN DESIGN & CONSTRUCTION
RECOMMENDED DEMOLITION & REMOVAL

BUILDING KEY

ID	Building Name	ID	Building Name
ART	VISUAL ARTS	KHA	KINESIOLOGY, HEALTH EDUCATION & AQUATIC COMPLEX
CYN	CANYON HALL	LRC	LEARNING RESOURCES CENTER
CNTL1	CENTRAL COMPLEX	MSO	MAINTENANCE & OPERATIONS
CNTL2	CENTRAL COMPLEX 2	NRTH	NORTH COMPLEX
CDC	CHILD DEVELOPMENT CENTER	PAC	PERFORMANCE ARTS CENTER
CTB	CLOCK TOWER BUILDING	PSAH	PUBLIC SAFETY & ALLIED HEALTH
CCR	CRAFTON CENTER	SSB	STUDENT SUPPORT BUILDING
CHL	CRAFTON HALL	WEST	WEST COMPLEX
EAST	EAST COMPLEX		
GYM	GYMNASIUM		

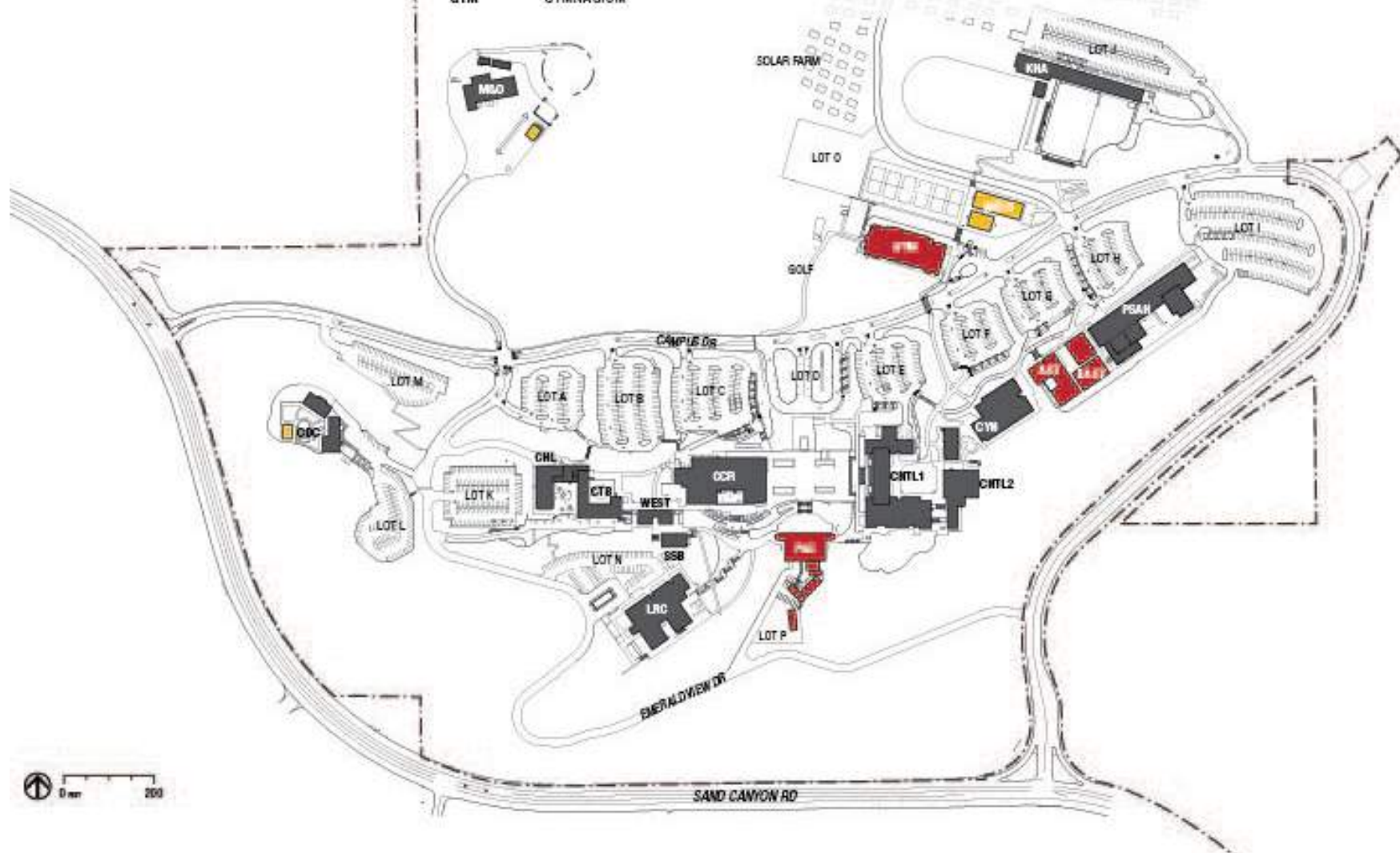

Facilities Analysis

OPPORTUNITIES - FUTURE BUILDING SITES - UPDATED

Removal of certain modular and aging buildings opens opportunities to improve the campus, provide future building sites, and address educational program needs. The removal of the Gymnasium opens the way for a new Performing Arts Center facility near the heart of campus and in an area that will enhance the “face” of the college and allows for a new Instructional Building to be constructed in its old location on the main quad, housing general purpose classrooms and Visual Arts.

The location of the Gymnasium near the Kinesiology, Health and Aquatics Center (KHA) will expand opportunities in kinesiology and athletics and create some efficiencies by sharing of common spaces such as locker rooms and showers. In addition, space will be developed for outdoor kinesiology labs, a collegiate-size soccer field and training facilities needed to support the development of collegiate athletic programs.

Over the past decades, the campus has grown within several functional zones, confirming that the cluster concept is an enduring and logical organizing principle for the campus. Functional clusters make sense for a hillside campus where adjacencies reduce the need to constantly traverse vertical distances. It makes sense that future campus development will reinforce this concept.

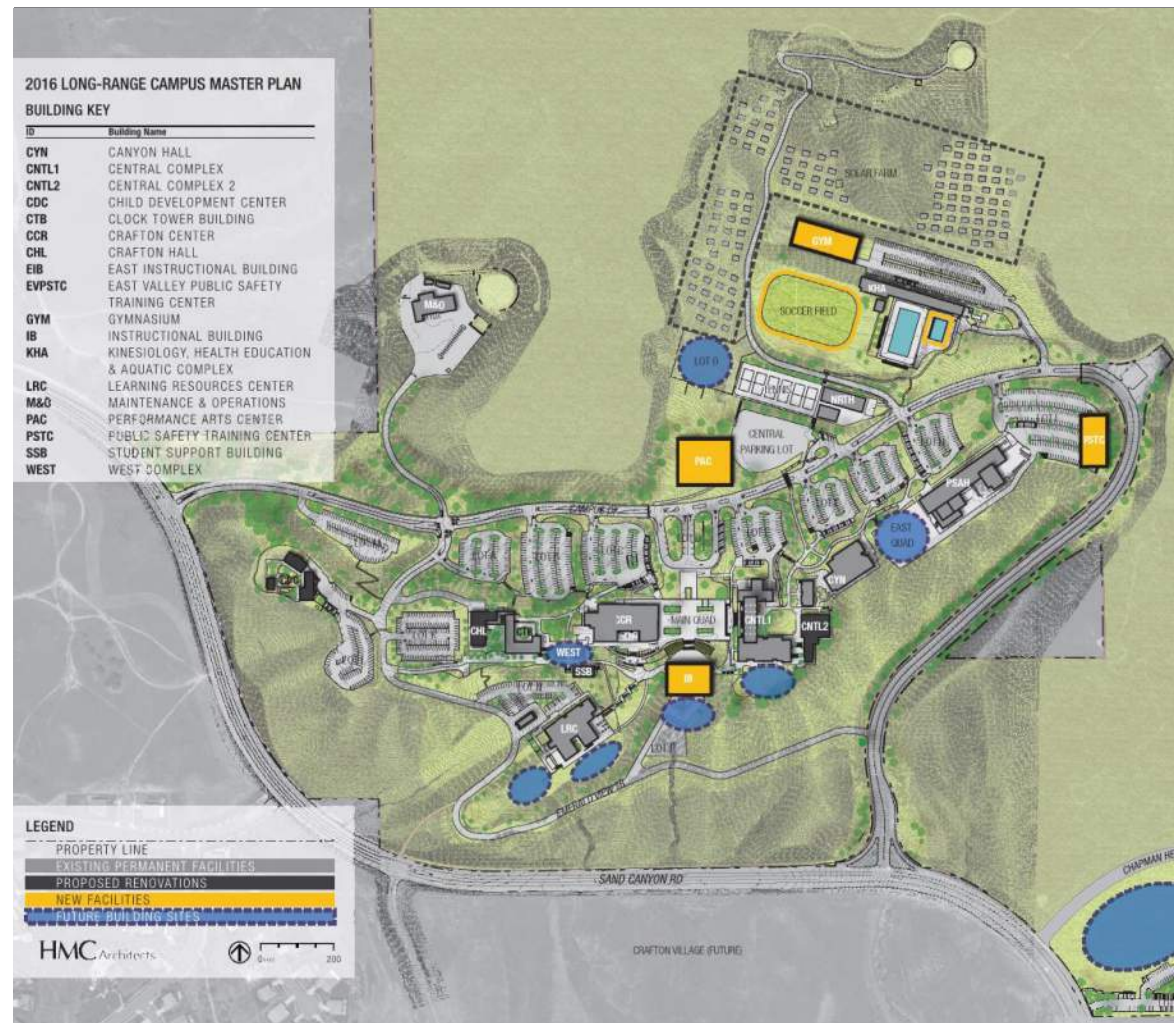

Removal of the Visual Arts Building clears the way to develop a larger Science cluster adjacent to Canyon Hall, which currently houses several science programs. New facilities in this area will provide laboratories, and instructional support spaces for future growth in Science focused programs. Removal of the East Complex opens up a student-oriented outdoor space that will join the Main Quad and Crafton Hall courtyard as valued outdoor places for socializing, eating, studying, or contemplating the view from this privileged place that welcomes every student. This East Quad will also have the opportunity to provide outdoor formal and informal instructional space for future Science expansion.

As the College focuses on creating engaged student activity on campus, consolidating instructional space together at the center of the campus, adjacent to Crafton Center, will assist in growing student energy at the heart of the campus. This centered energy will provide more robust opportunities for student interaction and enhance Crafton Hills' student-centered culture and community. Locating both the Visual Arts (in the new Instruction Building) and the Performing Arts at the center of the campus allows further exposure and integration of the Arts into campus culture—essentially becoming the “bookends” to the campus Quad.

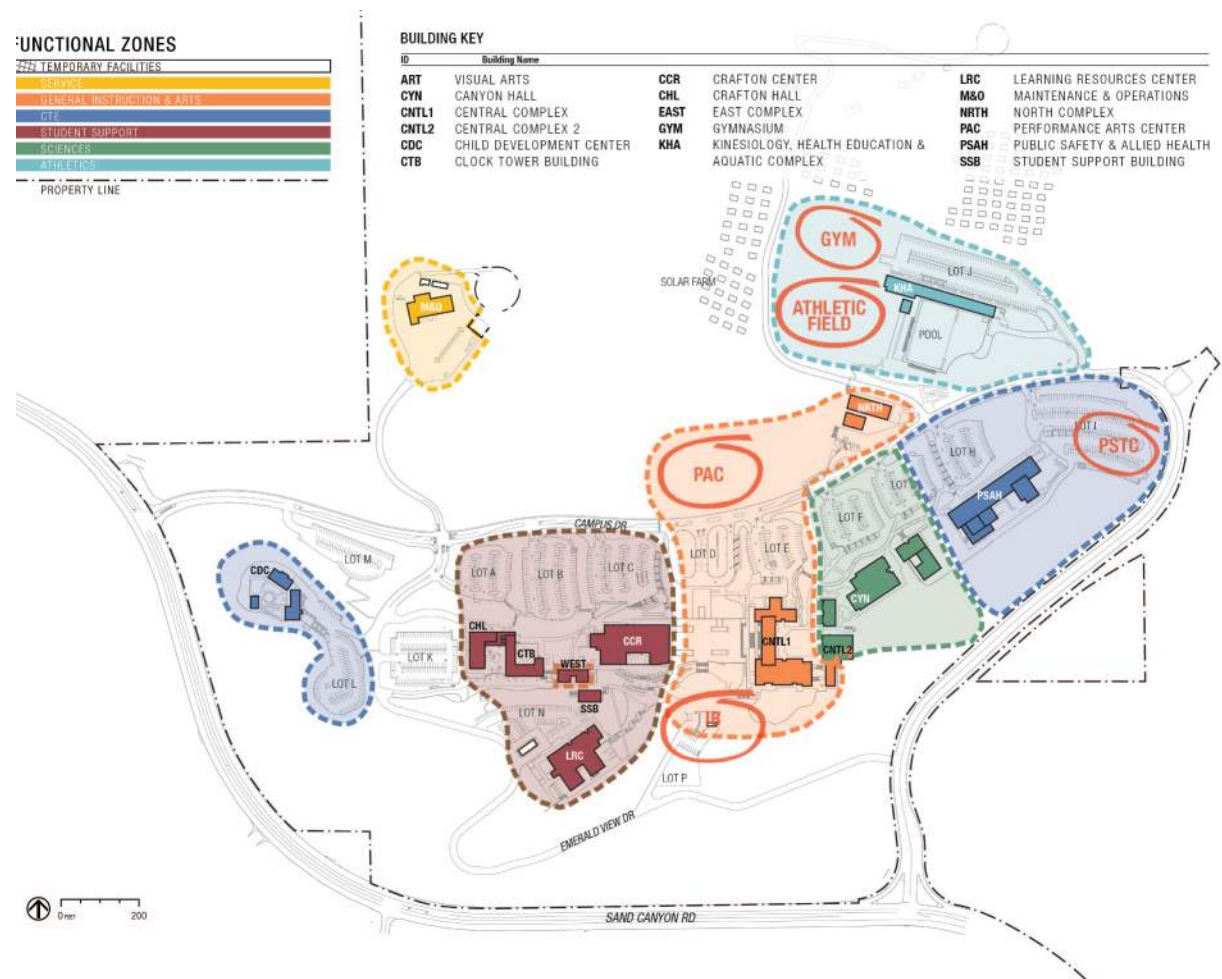

Recommendations

2021 LONG-RANGE CAMPUS MASTER PLAN - UPDATED

The 2021 Facilities Master Plan Addendum campus plan presents a concept for campus development that supports the strategic directions and priorities of the 2017 Educational Master Plan with a focus on creating a student-centered campus. The recommendations are intended to support the growth of the College into a mature and comprehensive institution.

Crafton Hills College is actively developing the skills of faculty and preparing students to learn in new ways. It is reaching out to serve an increasing proportion of students in its community. Through the projects listed below, the College will continue to develop its campus facilities, both indoors and outdoors, to better support these initiatives.

The recommendations are described in a series of capital construction and renovation projects, as well as initiatives for campus-wide improvement that are intended to be implemented in a flexible and phased manner. They also include steps to set standards and to plan for project implementation needs including logistical plans, site utilities infrastructure expansion, and sustainable design goals.

A key step that is required by accreditation standards is planning for the life-cycle and operational costs of all facilities and campus-wide systems. Only by doing this can Crafton Hills College expect to maintain and refresh the campus over time, at the level of quality that the community deserves and has come to expect.

PROJECT LIST

New Facilities

- › Performing Arts Center
- › Instructional Building
- › East Valley Public Safety Training Center
- › Gymnasium
- › Teaching Pool
- › Outdoor Kinesiology Laboratories

Renovation of Facilities

- › Crafton Hall Renovation
- › Student Support Building Renovation
- › Central Complex 2 Renovation
- › Child Development Center Renovation
- › West Complex Renovation

Campus-Wide Improvements

- › Enriched Environments for Student Activities
- › Campus-Wide Learning Environment Upgrades
- › Vehicular Circulation and Parking
- › Enriched Outdoor Environments
- › Security and Safety
- › Ancillary Logistics and Infrastructure

Exploration of Future Options

- › Potential uses of undeveloped campus land

2016 LONG-RANGE CAMPUS MASTER PLAN BUILDING KEY

ID	Building Name
CYN	CANYON HALL
CNTL1	CENTRAL COMPLEX
CNTL2	CENTRAL COMPLEX 2
CDC	CHILD DEVELOPMENT CENTER
CTB	CLOCK TOWER BUILDING
CCR	CRAFTON CENTER
CHL	CRAFTON HALL
EIB	EAST INSTRUCTIONAL BUILDING
EVPSTC	EAST VALLEY PUBLIC SAFETY TRAINING CENTER
GYM	GYMNASIUM
IB	INSTRUCTIONAL BUILDING
KHA	KINESIOLOGY, HEALTH EDUCATION & AQUATIC COMPLEX
LRC	LEARNING RESOURCES CENTER
M&O	MAINTENANCE & OPERATIONS
PAC	PERFORMANCE ARTS CENTER
PSTC	PUBLIC SAFETY TRAINING CENTER
SSB	STUDENT SUPPORT BUILDING
WEST	WEST COMPLEX

LEGEND

- PROPERTY LINE
- EXISTING PERMANENT FACILITIES
- PROPOSED RENOVATIONS
- NEW FACILITIES

HMC Architects



Recommendations

NEW PERFORMING ARTS CENTER - UPDATED

The Finkelstein Performing Arts Center (PAC) was one of the original brutalist architecture buildings of the Crafton Hill campus designed by Architect E. Stewart Williams and has served the College and the community well since 1978 when it was dedicated to Lester and Ruben Finkelstein, the brothers who donated the land for the Crafton Hills College's campus. It is an iconic building on the campus and the intention had been to try and renovate the facility. However, after much investigation the Facilities Condition Assessment and current code requirements determined that the 43-year-old facility would need complete renovation, including all systems and seismic upgrades. Per the current code, CAC 4-309 and DSA considerations, if the cost of the renovation is at least equal to or greater than 50% of the cost of a new facility, full replacement is required. The cost analysis on the existing PAC Renovation project highlighted that the building must be replaced.

The new PAC will be designed to meet the current and future instructional needs of the performing arts programs offered at the college. The facility could include a theatre as well as back of house facilities that will support both performances and the theatre department's instructional programs.



Vignette Plan

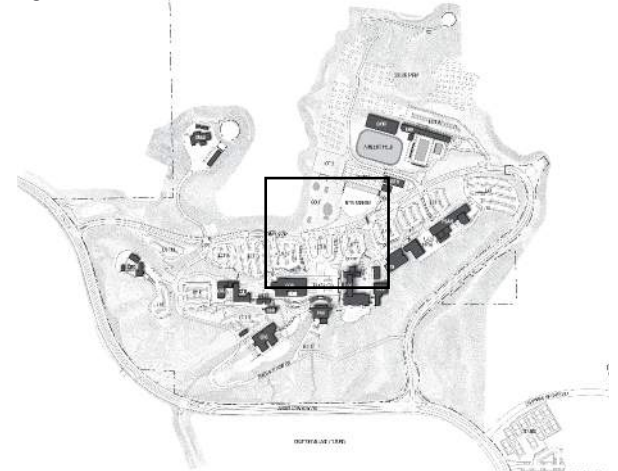

Key Plan



The photographs on this page are intended to illustrate ideas and inspire the design process for this project.

Recommendations

KINESIOLOGY + ATHLETICS FACILITIES - UPDATED

Crafton Hills College seeks to engage students and support the community through kinesiology instruction and competitive training and events. These projects, including completing the aquatic center, replacing the gymnasium, improving outdoor learning labs, and developing a collegiate-sized soccer field will improve facilities to support Crafton Hills College's kinesiology and athletic programs. All facilities would have the connectivity and infrastructure system to support modern instructional technologies and events. Universal accessibility and circulation linkages among all facilities will meet current building code requirements..

Gymnasium Replacement

The proposed new Gymnasium would provide modern kinesiology instructional labs. It would include instructional studio space for dance and fitness dance, classes in basketball, volleyball, badminton, and other programs. The Gymnasium could house team rooms, equipment and storage rooms, along with necessary facility support spaces. Space could be flexible for use and allow for 500-1000 bleachers to accommodate large indoor events. The project could consider expansion of Parking Lot J as well as access to trails, water tank, and cell towers..

The proposed location for the gym allows for increased

utilization and connection with the existing Kinesiology, Health and Aquatics Complex by sharing mutual spaces such as locker rooms. The location also allows for the expansion and improvements to the existing field into a regulation-sized soccer field. The adjacent hillside could be explored for potential spectator seating.



Vignette Plan

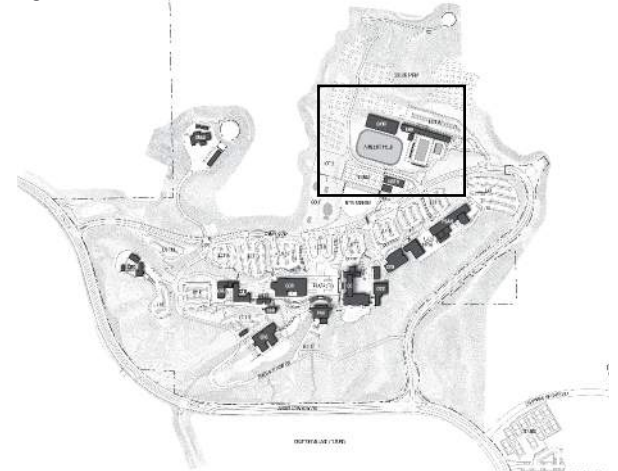

Key Plan



The photographs on this page are intended to illustrate ideas and inspire the design process for this project.

Recommendations

KINESIOLOGY + ATHLETICS FACILITIES *(cont.)*

Teaching Pool

Since 2010 the College's aquatic facility has been well-used for joint-use by the City of Yucaipa's competitive aquatics teams, and has been increasingly used for the College's instructional swimming classes, lifeguard training, high school competitive aquatics teams, and other regional aquatics clubs. This modern facility uses solar heat and smart pumps to operate sustainably. Its popularity has spurred the need to expand this facility with the addition of a teaching pool that will support additional instructional programs and use by community programs. The facility will house a team room, as well as pool circulation pumps and filtration equipment. The option for solar heating will be explored.

Outdoor Kinesiology Laboratories

Improvements will be made to outdoor athletic facilities that students use to develop and practice their skills in soccer, golf, track, and other instructional programs. The multipurpose field will be fully developed into a regulation-sized collegiate soccer field with water-wise synthetic turf, a walking/running track, and lighting for nighttime use. Options to provide audience seating will be explored. The existing 6-court tennis facilities may be remodeled with new paving and court markings.

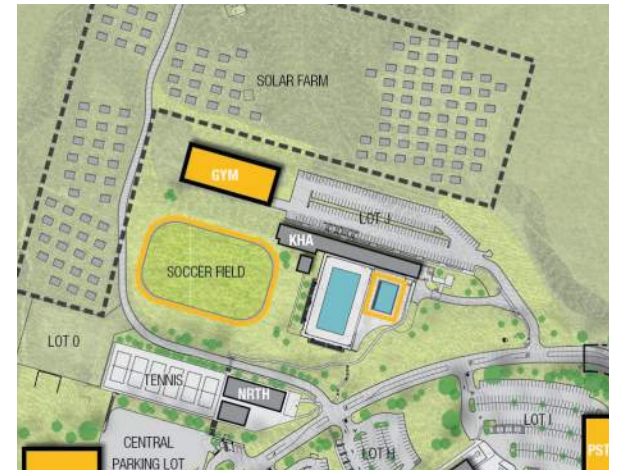

Vignette Plan

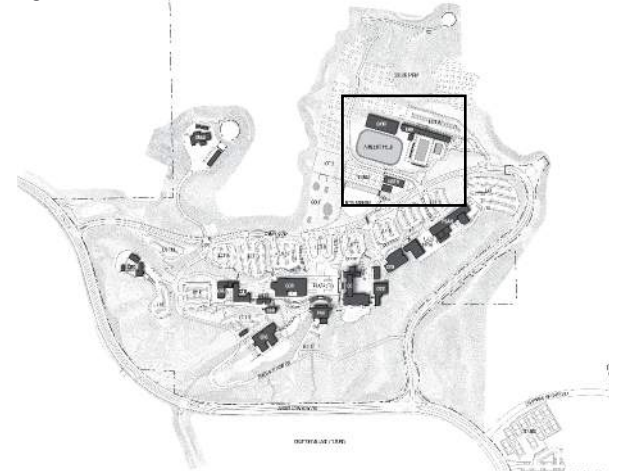

Key Plan



Recommendations

CRAFTON HALL RENOVATION - UPDATED

One of the iconic original campus buildings, Crafton Hall has served the College as its main food service and dining facility until 2016, when Crafton Center opened its doors providing food service. Crafton Hall will serve the College once again as its primary facility for meeting, conference, and event space. This would provide the college with the space for both internal and intra-collegiate meetings, conferences, and training, as well as fundraising and community events. The facility would also include faculty offices on the second floor as an annex to the Clock Tower Building's faculty wing to provide additional faculty offices as the campus grows. The renovation would upgrade the building's technology network infrastructure and connectivity, as well as other building systems, to simplify operation and increase efficiency.

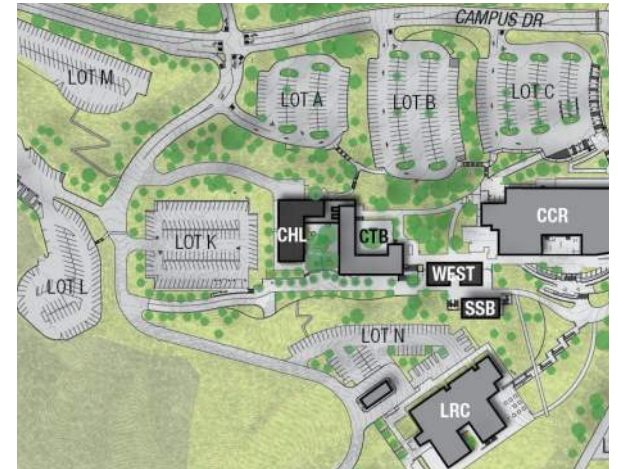

Vignette Plan

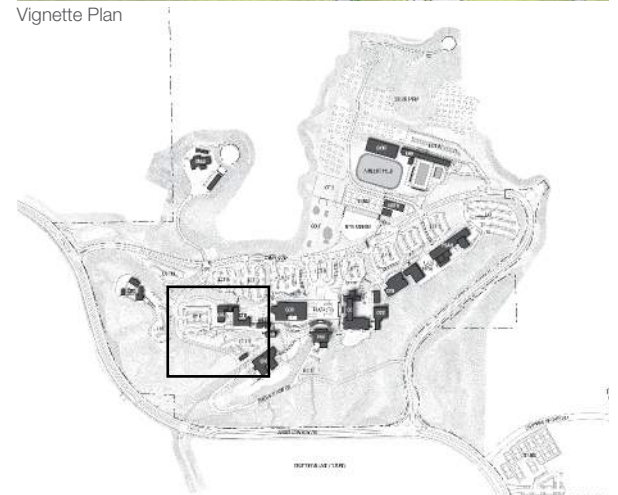

Key Plan



The photographs on this page are intended to illustrate ideas and inspire the design process for this project.

Recommendations

WEST COMPLEX RENOVATION - UPDATED

As future needs for Student Services continues to grow, additional space will be needed to accommodate programs and service space. To keep with the original intension of a One Stop Student Services facility, this growth need should be accommodated within the Crafton Center where Student Services is currently located. The West Complex, adjacent to Crafton Center, is an idea location to relocate the Administration from Crafton Center and allow for future additional space in Crafton Center to accommodate additional Student Services programs when the expansion is needed. Existing space in West Complex would be repurposed to administrative offices and support spaces. The option to bring natural light into the upper level spaces could be explored. Repurposing of space could also include upgrades to building infrastructure and other building systems, to simplify operation and increase efficiency.

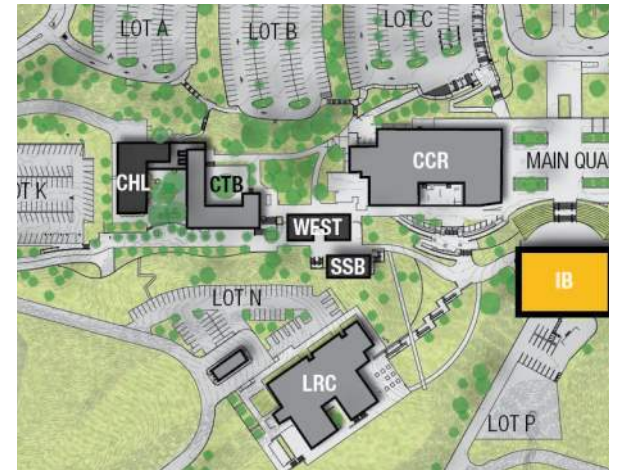

Vignette Plan

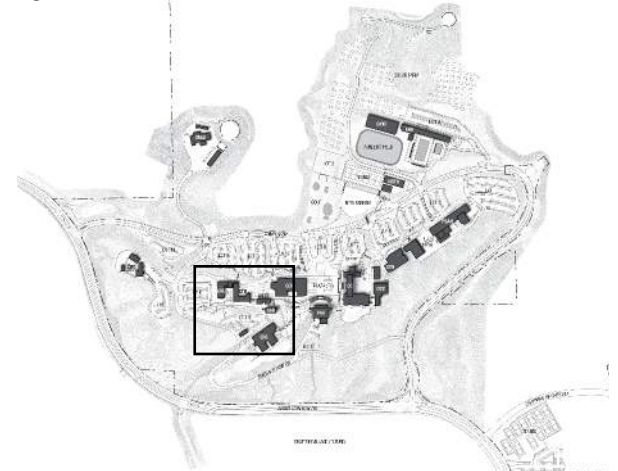

Key Plan

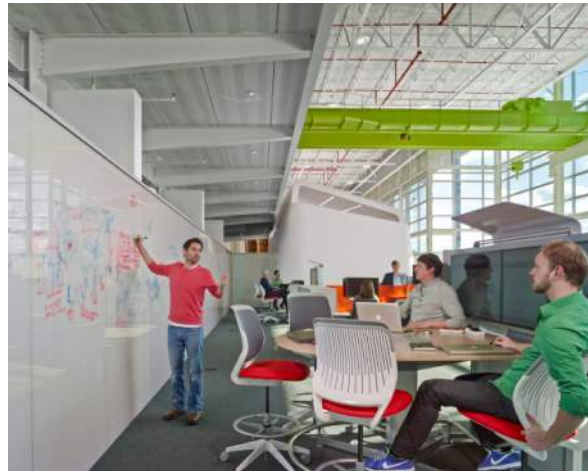

The photographs on this page are intended to illustrate ideas and inspire the design process for this project.

Recommendations

STUDENT SUPPORT BUILDING RENOVATION - UPDATED

Following the construction of Crafton Center, many student services offices moved out of the Student Support Building. The vacated space could be renovated to expand existing services and house new services. The Student Health & Wellness Center could expand on the first floor to accommodate counseling space for expanded mental health services and provide a space for student support offices. Space on the second floor could be renovated to accommodate several new active learning classrooms. Renovation will include upgrades of systems to improve operational efficiencies.

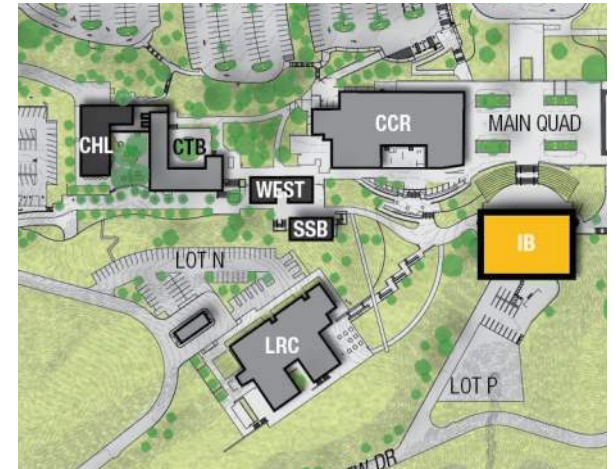

Vignette Plan

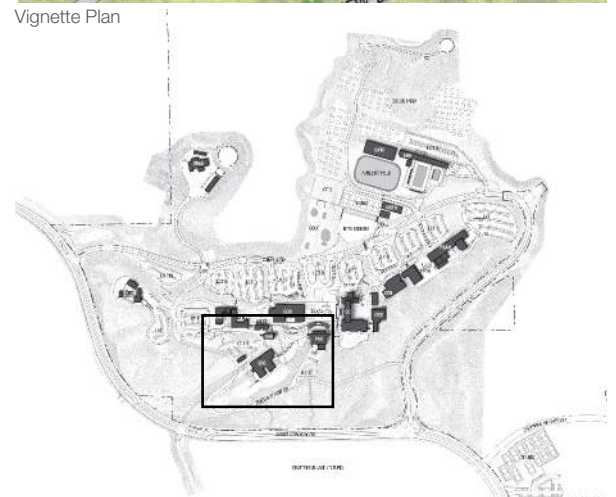

Key Plan



The photographs on this page are intended to illustrate ideas and inspire the design process for this project.

Recommendations

NEW INSTRUCTIONAL BUILDING - UPDATED

The new Instructional Building would provide space for general active learning classrooms as well as space to house the Visual Arts Program including studios for visual arts and art history instructional space, the art gallery, and studio support space. The new building would also house a centralized tutoring center bringing tutoring close to instructional classrooms at the center of campus. This new building provides the opportunity to include student-centered informal gathering spaces both inside and outdoors to make this building a vibrant hub for student activity on campus.

The new building will be located in the former location of the Finkelstein Performing Arts Center, at the center of the campus and adjacent to instructional space in Central Complex 1 to the east and Student Services in the Crafton Center to the west. The building will be a “bookend” in the Main Quad with outdoor space that can be developed to support art exhibits, and permanent art sculpture, student gathering space, and club activities. The location also increases public accessibility and interest to the arts as part of the campus culture.

The completion of the Instructional Building would likely lead to modifications in the Library Resource Center. The minor renovation of the LRC will repurpose space on the first and second floor currently being used for a tutoring annex (the old copy center), tutoring, art gallery, and other miscellaneous functions that will be moved to the new Instructional Building. This frees up space for efficient, active learning classrooms on the 1st and 2nd floors that will increase the utilization of these spaces and increase the student-learning culture in the Library.

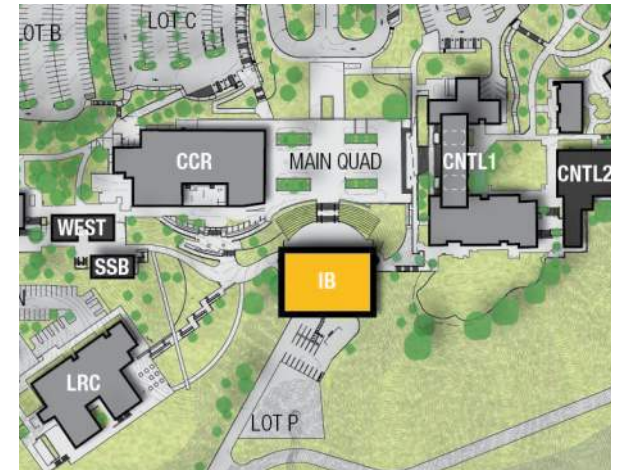

Vignette Plan

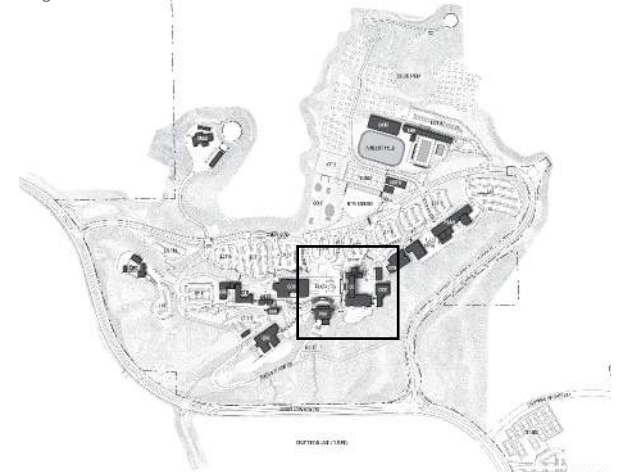

Key Plan



The photographs on this page are intended to illustrate ideas and inspire the design process for this project.

Recommendations

CENTRAL COMPLEX 2 RENOVATION - UPDATED

This project will upgrade antiquated and aging facilities and optimize utilization by resizing these spaces to rebalance the space inventory and align it with class sizes and instructional needs. The first floor will be renovated to accommodate general purpose active learning classrooms. Second floor space will be redeveloped to house earth sciences and a flexible space that will accommodate growth in anthropology. Secondary effects of the Central Complex 2 renovation will include minor updating of lab space in the temporary modular buildings, North Complex, that will be used until a new future Science building is constructed on the East Quad. This renovation will upgrade the building's technology network infrastructure and connectivity, as well as other building systems, to simplify operation and increase efficiency. As one of the campus' early buildings, this renovation will extend CC2's useful life and help to preserve an important part of the College's architectural heritage.

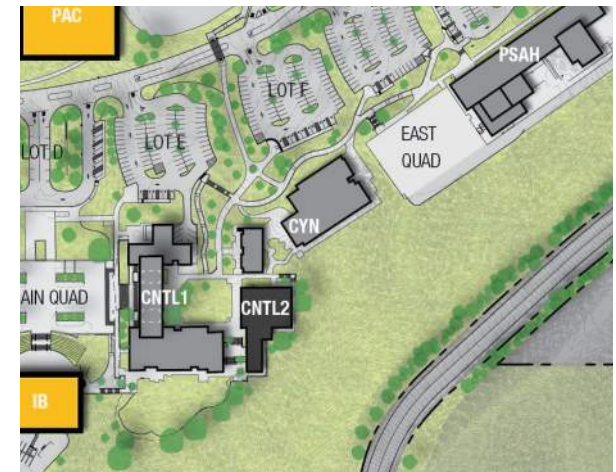

Vignette Plan

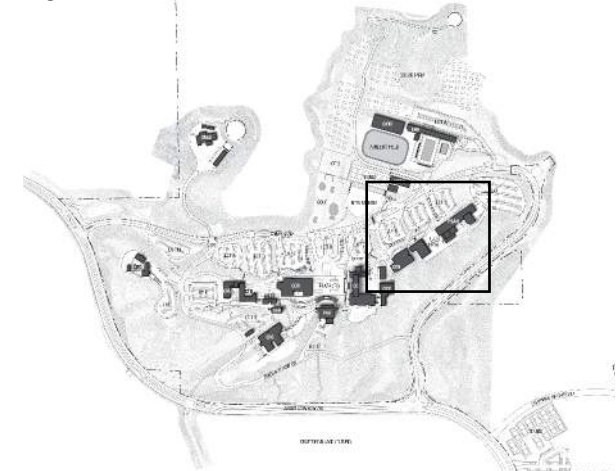

Key Plan

The photographs on this page are intended to illustrate ideas and inspire the design process for this project.



The photographs on this page are intended to illustrate ideas and inspire the design process for this project.

Recommendations

MAINTENANCE + OPERATIONS ADDITION - DELETED

The need for the addition project to the Maintenance and Operations facility has been cost effectively addressed by relocating a temporary structure used in the previous bond program to the M + O service area to provide office space for facilities staff. This project is no longer needed in the facilities master plan.



Vignette Plan

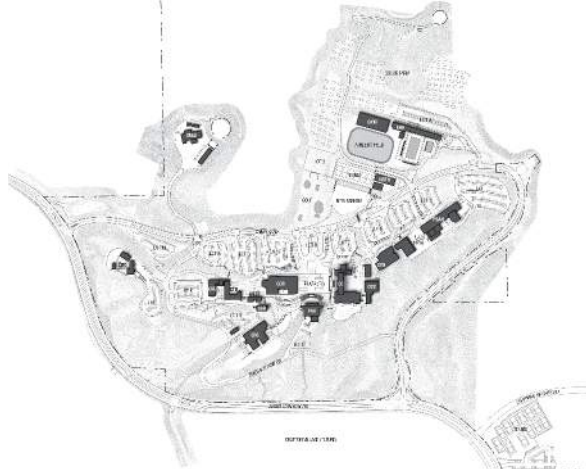

Key Plan



The photographs on this page are intended to illustrate ideas and inspire the design process for this project.

Recommendations

CHILD DEVELOPMENT CENTER RENOVATION

This project will modernize the Child Development Center (CDC) facilities, which house the Early Education Program's instructional demonstration classrooms and the preschool program that serves the community. The facilities include three buildings and outdoor instructional play areas, which have been in service for two decades.

Visual screening and security of the outdoor play areas will be upgraded. Vehicular circulation will be improved within the parking lot and an accessible pedestrian path of travel to the CDC will be completed. The aesthetic quality of the front entrance to the CDC will be improved with landscaping and enhanced paving.

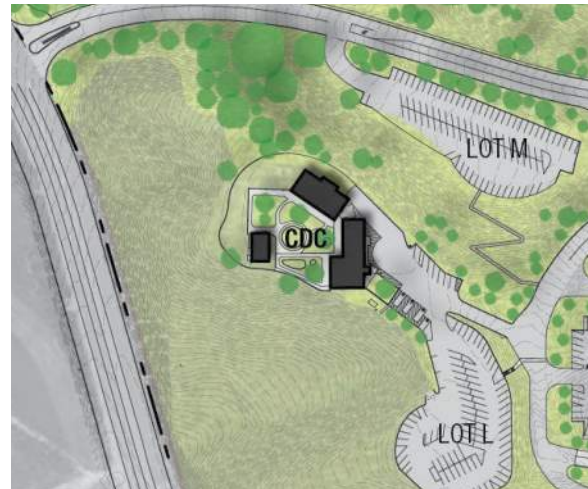

Vignette Plan

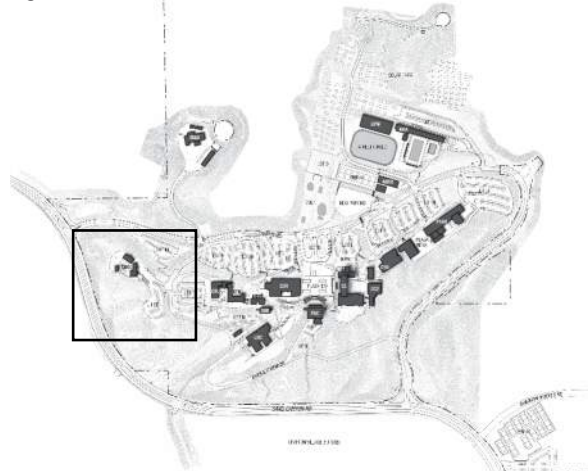

Key Plan



The photographs on this page are intended to illustrate ideas and inspire the design process for this project.

Recommendations

EAST VALLEY PUBLIC SAFETY TRAINING CENTER - UPDATED

Crafton Hills College's highly regarded Public Safety Programs train fire, rescue, EMS, and hazardous material personnel to respond to multi-hazard/multi-jurisdictional emergency incidents. These programs draw new students and working professionals and generate revenue for the College. Specialized trainings are developed within a partnership among San Bernardino Community College District, Crafton Hills College, and local and regional fire agencies.

This project provides facilities in which to train students in conditions that replicate real-life emergency incidents. It will complete the training facilities at Crafton Hills College's Public Safety and Allied Health Building, which opened in 2016.

The East Valley Public Safety Training Center will include a smoke-less burn tower and other training props. The center will be located on the edge of existing Parking Lot I, and near the PSAH Building.

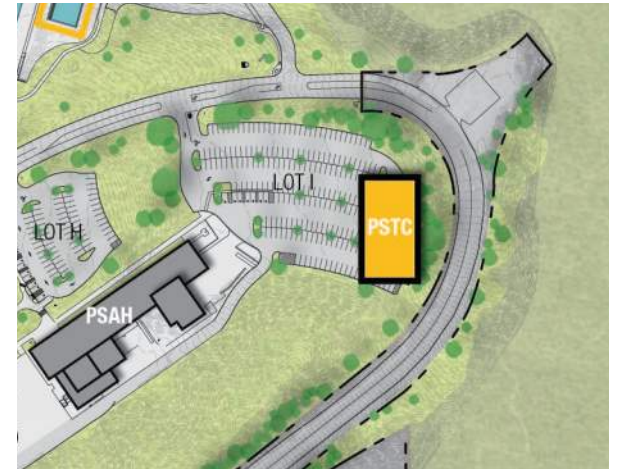

Vignette Plan

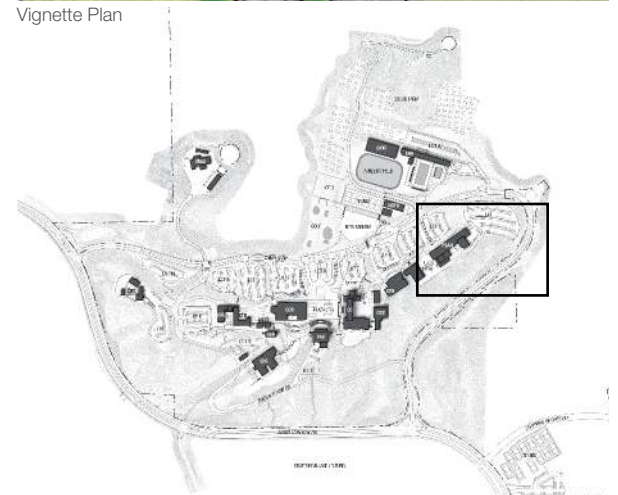

Key Plan

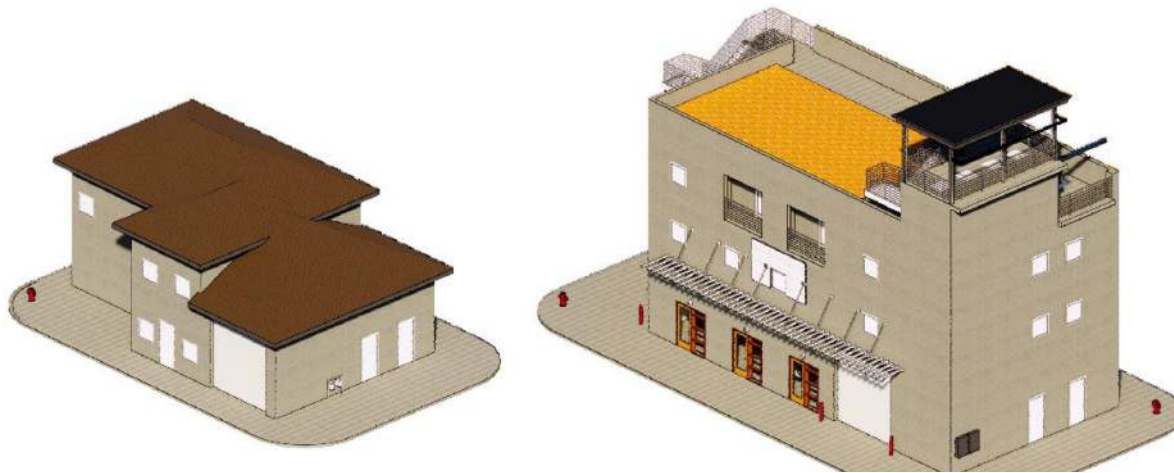

The photographs on this page are intended to illustrate ideas and inspire the design process for this project.

Recommendations

CAMPUS-WIDE ENRICHED ENVIRONMENTS FOR STUDENT ACTIVITIES

Building on the success of Crafton Center, which opened in 2016, this project will take the next step to fully outfit key existing interior and outdoor spaces into student-centered environments that invite social interaction and enjoyment of all that Crafton Hills College has to offer.

Consider following the example of popular community dining spots and coffee houses, and provide furniture, fixtures, and equipment to create the atmosphere of a student hub within and around Crafton Center. Equipment and furniture should be portable and readily storable for times when these spaces are needed for other uses.

- › Furnish a portion of the Road Runner Cafe with a variety of seating options and table heights. Include a number of locations equipped for small music performances and poetry readings.
- › Provide lounge furniture and recreational equipment to fully furnish the Office of Student Life and the Crafton Center lobby.
- › The Crafton Center Patio and Courtyard, the Living Wall, the Main Quad will be fully equipped and furnished to support student gathering,

recreation, and informal learning. Include outdoor dining tables with umbrellas for shade and lighting for night time gathering and social activities.

- › Explore performance opportunities of many types as focal points for student gathering. Build and equip a small outdoor performance area with a permanent stage and open mic in the Crafton Center Patio outside the Bookstore.
- › Network connectivity through the campus WiFi system will be extended to cover outdoor areas to support instructional and social activities using both college- and student-owned devices.
- › Music has the power to enliven the campus environment in a way that speaks to students of all backgrounds. In addition to hosting live music performances, explore an audio system with the flexibility to provide music and other content that is synchronized through selected interior and exterior spaces where students gather. Consider portable and scalable WiFi-based systems that are commercially available.
- › Encourage a culture of arts appreciation by

providing public spaces to display visual art created by students throughout the campus.

The large entry halls on the first and second floor of the Learning Resources Center often attract students who enjoy the expansive views and quiet atmosphere. Fully furnish these spaces, as well as the outdoor atrium and patios, to better accommodate students who wish to study and socialize.

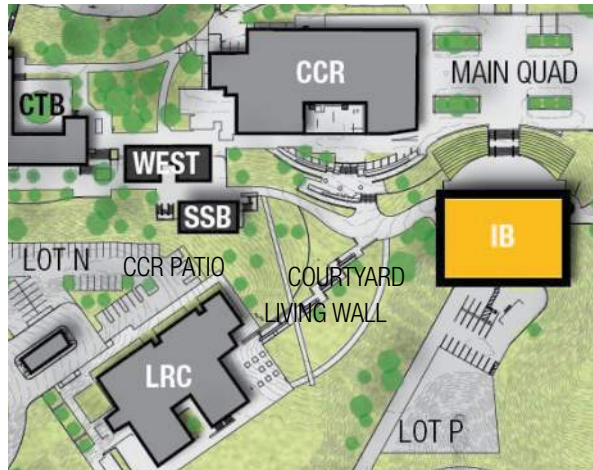

Vignette Plan

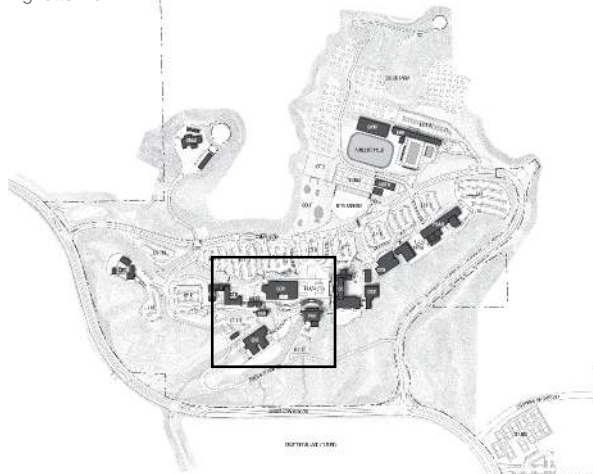

Key Plan



The photographs on this page are intended to illustrate ideas and inspire the design process for this project.

Recommendations

CAMPUS-WIDE LEARNING ENVIRONMENT UPGRADES

Learning and student development can and should take place in all areas of the campus, from informal conversations outside of class to the discussions and investigations that take place in a classroom, lab, or tutoring space. The renovation and upgrades of existing instructional buildings and spaces provide the opportunity to create instructional, collaboration, and tutoring spaces that focus on the current needs of students and faculty for today's learning. These redeveloped spaces should be flexible to allow for a variety of instructional approaches, including direct presentation, group work, project-based learning, class discussion, and role playing. All of these learning and collaboration experiences can take place in a variety of spaces all over the campus.

Instructional Spaces

Redevelopment of instructional spaces, particularly lecture classrooms, should consider student class size and average number of contact hours. A variety of instructional room sizes will provide options for scheduling courses in a space that aligns with the enrollment size of a particular course.

The flexibility of space development with furnishings and technology can encourage creative approaches

to discussions, project-based learning, and teamwork rather than restricting process, thought, and collaborative development. Faculty in each classroom or lab need to feel empowered to re-arrange and create a space to suit their specific instructional needs. Redeveloped instructional spaces should include mobile furnishings on casters that can easily be reconfigured to support various modes of instruction. Engagement of students could be increased with a layout that provides for small group discussions and activities, rather than rows of individual desks.

WiFi access to allow for use of tablets, laptops, and mobile devices should be included in all instructional spaces throughout the campus. Power for charging devices should also be included along all walls. Opportunities for multiple large flat-screen monitors on the walls and multiple large front projection screens will increase visibility for direct presentations and allow for small group work. As technology changes, new technology options should be implemented to encourage the latest methods of research and interaction with information beyond the walls of the college.

Distance Learning

As distance learning and blended learning opportunities increase at the College, consideration should be given for additional testing locations for these courses as well as touch points for interaction with faculty and other students for personal contact and mentoring. Faculty office areas should be augmented with small conference rooms or group rooms to allow for more flexibility to meet with multiple students and to provide locations for faculty interaction. A Distance Learning Support Center should be considered to serve these needs.

Corridors and Public Spaces

Public spaces are essential to the daily campus life of students, faculty, and staff. They foster a wide variety of activities and support informal, spontaneous interactions and socializing that can lead to a culture of trust, collaboration, sharing, and informal learning from others. Clear sightlines to these areas should be considered for security. The redevelopment of all buildings and surrounding outdoor spaces should focus on the opportunities these transitional spaces can provide.

Planning the campus' facilities should strategically distribute a mix of quiet and lively, public and semi-private spaces, such as cafés, common areas, and study rooms

throughout all buildings. They should be created within easy-to-locate areas, such as lobbies, corridors, outside classrooms and offices, and outdoors. Consideration should be given to designing a variety of configurations of spaces for various uses. These informal learning and collaboration spaces should support a variety of student activities, including study and informal tutoring, waiting between classes, socializing, interactive dialogue between students and instructors, reading, and using technology devices. All areas should consider the need for power to charge technology devices.

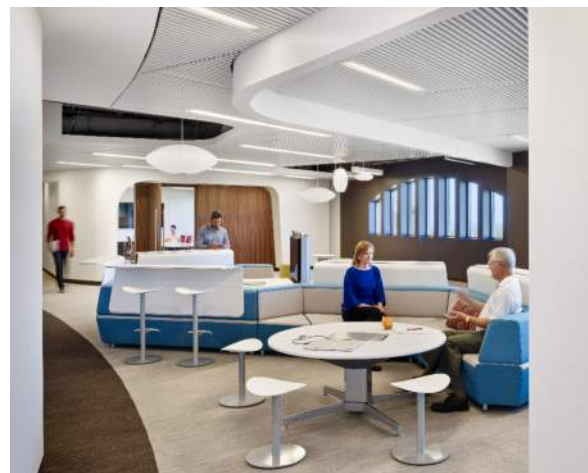

The photographs on this page are intended to illustrate ideas and inspire the design process for this project.

Recommendations

CAMPUS-WIDE VEHICULAR CIRCULATION + PARKING

Campus Entries

Improvements are recommended for the two vehicular campus entry points. More visible and consistently designed signage is recommended at both entrances. Improvements are recommended for the western entry at the intersection at Sand Canyon Road and Campus Drive. Consider widening Campus Drive to provide more maneuvering space for vehicles that are entering and leaving the campus and a wider separation between vehicles and bicycles.

Removal of On-Street Parking

Currently 180 on-street parking spaces exist on the north side of Campus Drive within the campus property. Removal of these stalls will reduce the number of pedestrians that jaywalk across Campus Drive and improve safety and the flow of traffic.

Transit Stops & Passenger Loading Zones

Currently many students are dropped off and picked up at the campus by family and friends. As the use of shuttles, ride-sharing, and ride-hailing becomes an even greater proportion of vehicle trips to campus, the need for passenger loading zones with adequate vehicle stacking space will grow. Providing dedicated loading zones reduces congestion in parking lots that currently serve as informal waiting and loading zones. Parking Lot D currently functions well as a transit stop and passenger

loading zone at the center of campus. The development of a secondary loading zone near the East Quad and accessed from Lot G is recommended.

Bicycle Facilities

Due to the campus' hillside location, commuting by bicycle is not common, however, the benefits of cycling, with regard to fitness and sustainability, make it worth encouraging. Yucaipa Boulevard is a Class 2 bicycle route and Sand Canyon Road provides a connection to Campus Drive. It is recommended that the College and City explore options to make improvements that extend a bike route from Yucaipa Boulevard to both campus entries.

Once on-street parking is removed, Campus Drive is recommended as a shared bicycle route. Signage along Campus Drive and other paths shared with vehicles or pedestrians will promote awareness of bicycle traffic. Many existing campus pedestrian and vehicle routes have the capacity to serve as bicycle routes and should be designated with signage placed next to or painted on the pavement. Signage should be extended to Parking Lot J near the Gymnasium, where secure parking and access to showers would be provided. Secure bicycle parking areas should be created. Options should be explored for the addition of electric bicycle rental stations.

Parking

Although Crafton Hills College's existing parking capacity is sufficient to accommodate the level of enrollment that is planned for 2031, the FMP recommends a modest redistribution and increase in the number of parking spaces that will improve circulation flow, safety, and convenience.

- › Central Parking Lot: Once the inactive gymnasium is removed, a permanent parking lot will be built on its site. Accessible pedestrian paths will connect the new parking lot to the two existing Campus Drive crosswalks at Lot D and F. The Central Parking Lot will be visually screened with landscaping along its southern and western edges to maintain a park-like appearance. Please refer to *Considerations for the Future, Central Campus* for further recommendations regarding the ultimate use of the Central Parking Lot.
- › Permanent Parking Lot N: The portion of Parking Lot N that is surfaced with gravel will be provided with permanent paving.
- › Temporary Parking Lot O: Parking Lot O will be maintained for construction vehicles in the near term. Please refer to *Considerations for the*

Future for further recommendations regarding the ultimate use of Parking Lot O.

- › Emerald View Drive, Parking Lot L, and the CDC Parking Lot: An accessible pedestrian path will be built between Lot K—with a connection to the western end of The Promenade—and Lot L, via a raised and highly visible crosswalk. Nighttime lighting will be provided for Emerald View Drive along the approach to the crosswalk from both directions. The accessible path will be extended to the entrance of the Child Development Center and the accessible parking in the CDC Parking Lot. In Lot L, the damage due to settling of improperly placed earthen fill will be addressed. The CDC Parking Lot will be reconfigured to provide universally accessible and improved access for parents and their children. Landscape planters and enhanced paving will be incorporated into the CDC Parking Lot to provide a more welcoming appearance that complies with college design standards.

Considerations for the Future

Looking beyond the planning horizon for this FMP, SBCCD and Crafton Hills College should continue to implement policies and programs that encourage the

use of alternative transportation modes that help to reduce the parking utilization rate among students and employees. Given the suburban and semi-rural nature of the College's neighborhood context and the initiative to attract students from a wider geographical area, it is likely that the College will need more parking capacity in the decade following 2031. To address this need, the College is encouraged to seek community partnerships and joint-use agreements for nearby off-campus parking. The development of College Village will present an opportunity to build shared parking at College Village. With a shuttle providing frequent service between the two sites, parking could be planned to serve the needs of both the College and its partners in College Village.

Three potential parking structure sites are identified. Although the decision to build a parking structure need not be made at this time, a site or sites should be reserved for the time when a parking structure is needed.

- › Central Campus: This hillside site; which encompasses the existing gymnasium, the tennis facility, North Complex, and a portion of Parking Lot O; could be accessed from both Campus Drive and the Fire Road. A structure could be built into the hillside, and could serve facilities in the upslope and downslope directions. This central

location is near to most of the other facilities, and yet it would not claim prime space along either of the main building axes. The top deck of a parking structure provides a potential location for many uses; including athletic facilities, such as tennis courts, or an additional solar photovoltaic installation.

- › East Campus: A site in Parking Lot I at the eastern and uphill end of the developed campus is closest to the Science & Career Pathways and Kinesiology Clusters. A parking structure in this location would draw in vehicles approaching from the east and lessen traffic in the surface parking lots.
- › West Campus: A site near the western and downhill end of the developed campus is closest to the Arts and Civic Clusters. Previously, SBCCD planned for a parking structure in Parking Lot K. Another site option lies in the area of Parking Lot A and B, which is set at a lower level behind the main building axis along The Promenade and is less desirable as a location for a building.

Recommendations

CAMPUS-WIDE ENRICHED OUTDOOR ENVIRONMENTS

Every part of the campus is an opportunity to promote learning and reinforce Crafton Hills College's vision and values. A rich campus experience is one that attracts and engages students and invites them to use the campus to further their growth and educational goals. Providing opportunities for students to interact with and actively use the campus should be a key driver of campus design. As the programming is determined for the renovation and construction of buildings and outdoor spaces, such opportunities should be sought with input from students, faculty, and staff.

Embracing the Importance of the Arts on Campus

One of the College's goals is to embrace the importance and appreciation of art on campus, as a way to solidify the College's identity and sense of community. Public art displays amongst different campus environments create a cohesive tone throughout. These spaces can be both indoors, in common areas—not just in facilities that serve the arts department—as well as outdoors. Outdoor spaces for intimately-scaled performance art (music, theatre) could also be incorporated in many places, encouraging the integration of arts in students' lives. The widespread incorporation of the arts across campus can also serve to make the campus a cultural destination for its students, staff, and the surrounding community.

East Quad

The East Quad will be the primary open space for the eastern campus—extending the original building spacing and massing concept. Students will be engaged within a social environment enriched with opportunities for gathering, studying, having coffee or eating a quick meal with fellow students. The East Quad creates a space for students to pause and orient themselves via the expansive views that characterize this campus. Located between the PSAH Building and a future Science Instructional Building, the Quad is an opportunity to express themes that relate to the instructional disciplines being learned therein. Incorporating a secondary food service facility into the East Quad or within the area is recommended.

The Campus as a Living Laboratory

The Science Learning Garden at Canyon Hall is an example of an outdoor space that reinforces the instructional theme of disciplines being learned. This concept will be applied throughout the campus, guided by the zoning of the campus as shown on page 3.053. In recent years, the campus has been transformed through the ongoing development of new facilities. Both existing and planned future developed areas will be seen as opportunities for Living Lab enhancements that grow organically out of available opportunities. Ideas heard from many quarters include:

- › Themed learning gardens
- › Student performance opportunities – mini-stages, musical instruments
- › Display of student work – pop-up project platforms, display walls and kiosks, flat screens
- › Community garden and the coaches pantry
- › Display of individual and team achievements
- › Fitness stations and par course

Service Zone

The Crafton Hills College campus is a large and complex entity to manage and operate. Knowledgeable and forward-thinking staff have set ambitious goals for efficiency, health and safety, and sustainability. To achieve these goals, they have implemented cutting-edge solutions such as the Solar Farm. The campus should be viewed as a living laboratory for teaching about solar power generation, operational systems, water quality, district heating and cooling. Doing so is one of the best opportunities to incorporate sustainability into the College's curriculum.



The photographs on this page are intended to illustrate ideas and inspire the design process for this project.

Recommendations

CAMPUS-WIDE ENRICHED OUTDOOR ENVIRONMENTS *(cont.)*

Natural Habitat Learning Lab

Explore opportunities to develop the land owned by the College and managed through the partnership with the Crafton Hills Open Space Conservancy. As the land owner and a key member of the conservancy, the College is well-positioned to use this unique asset. For example, explore the opportunity to engage students in research focused on management and preservation.

Consider building new trail connections, a cross-country and mountain biking circuit, educational exhibits and outdoor classrooms in which to learn about subjects such as native ecology and bio-diversity, local history, geology, wildfire management, and astronomy.

Recommendations

CAMPUS-WIDE SECURITY + SAFETY

SBCCD and the College will take a proactive approach to the security and safety of the campus including designing outdoor and building space using CPTED (Crime Prevention through Environmental Design) design principles and best practices for creating secure environments. This approach will be augmented with electronic security and safety systems. Projects to upgrade systems can be done as new buildings and site areas are built, as existing facilities are renovated, or as specific security systems are brought on line. The implementation of these upgrades should be coordinated with the campus police and a campus-wide safety and security plan.

Projects include:

- › Expand the electronic access control system to control access to all buildings.
- › Install digital CCTV security cameras and monitoring system in parking areas and other key areas of the campus.
- › Expand the intrusion alarm system on campus to include key spaces on campus.

- › Install a campus-wide emergency notification system through the fire alarm system and include exterior speakers to cover key areas of the campus.
- › Set in place emergency evacuation procedures and guidance systems that direct occupants to the preferred campus exit.



Key Plan

The photographs on this page are intended to illustrate ideas and inspire the design process for this project.

Recommendations

ANCILLARY LOGISTICS + INFRASTRUCTURE - UPDATED

Developing new facilities, roads, and infrastructure on an active campus requires a rigorous and logistically-sound approach. New facilities must be integrated into existing systems, which, in turn, must be upgraded to accommodate increasing loads. Simultaneously, campuses must evolve to keep up with new regulations and standards for sustainability and efficiency—a responsibility that community colleges have embraced as an extension of their educational mission and as stewards of public resources.

Temporary Facilities and Logistical Planning

San Bernardino Community College District and Crafton Hills College will plan and budget for relocating occupants and providing temporary housing and parking when needed. Simplifying logistics is a key factor for the order in which projects will be built. Temporary space will be provided only when necessary for programs whose existing facilities must be demolished or removed before new or renovated facilities are ready to be occupied.

Sustainability Planning

Continued sustainable facilities planning is recommended to build upon Crafton Hills College's successes and set milestones toward achieving net-zero energy usage

and other sustainability goals. Next step strategies to consider include:

- › Ultra-efficient building design standards
- › Micro-grid and battery storage
- › Fuel cell electrical generation
- › Sub-metering of all systems
- › Online dashboard that shows power generation and water and power usage
- › Retro-commissioning on a 3- to 5-year cycle
- › EV charging stations
- › Upgrades to existing Solar Panels

Site Utilities Infrastructure Study

A comprehensive utilities infrastructure study is recommended as the next step to support future facilities with vital services and prepare and budget for efficient and sustainable campus operations.

The campus utilities infrastructure will be mapped and assessed with regard to condition and the capacity to respond to planned needs. This FMP will serve as the basis to estimate and plan for future needs. The study will begin by thoroughly mapping, documenting, and assessing the condition and capacity of all existing systems. It will model future needs and plan

for improvements to the campus' space heating and cooling, power (including increasing site generated power), natural gas, communications, potable water, expanded use of non-potable irrigation water, sewer, and storm water management systems. It will consider emerging technologies and infrastructure systems that support the efficient use of resources and reduce the campus' environmental impacts.

The Kinesiology Precinct will require a greater degree of improvement than the other more developed parts of campus. It is known that the electrical system capacity and the communications network central core backbone must be expanded in this precinct. In addition, recently enacted water quality regulations have applied more stringent requirements for retention and treatment on college projects. The development of the Kinesiology Precinct must be accompanied by upgrades to the existing storm water system. Regulations also require a campus sewer management plan and SBCCD and the College are currently studying the existing sewer infrastructure and identifying needed repairs and upgrades.

Central Plant Expansion

The College's existing central plant is being utilized near its full capacity for cooling. To support the future development of the campus, capacity for additional cooling will be developed and hydronic piping will be extended to serve new buildings. This FMP will serve as the basis to model and plan for future needs. As noted above, the infrastructure in the Kinesiology Precinct will require a greater degree of development, and this holds true with regard to the hydronic pipe loop. This precinct should also be considered for a secondary central plant if one should be recommended by the infrastructure study.

Learning Resources Center Repurposing

Although not intended to be a capital construction project, this work will play an important role in re-zoning functions across the campus and addressing the secondary effects of recently completed buildings. It will update technology systems and connectivity and repurpose space to keep pace with changes in the delivery of academic support services and learning resources. It will expand and update the Professional Development Center to better support and prepare faculty to take advantage of emerging tools and modes of instruction. In addition, it will provide homes for the

following:

- › Office of Institutional Effectiveness, Research, & Planning
- › Distance Education Support Center
- › Update technology systems and connectivity

Equitable Access to Facilities

As part of Crafton Hills College's initiative to welcome and accommodate every person in the community that it serves, the College plans to provide all-gender restroom facilities for students, staff, and faculty in convenient locations throughout the campus. These facilities will provide safe and private single-user spaces for the use of all people.

Recommendations

EXPLORATION OF FUTURE LAND USE OPTIONS - UPDATED

SBCCD AND Crafton Hills College have the opportunity to explore revenue generating development in the open areas of the campus which are not currently be used including the college property located at the corner of Chapman Heights and Sand Canyon Road. Exploration could consider a sustainable mix of land uses including educational, retail, and housing. Opportunities could potentially include the following:

- › Restaurants and eateries
- › Retail and commercial space
- › Middle college high school
- › Housing
- › Joint-use facilities
- › Sports Facilities





Recommendations

IMPLEMENTATIONS - UPDATED

An implementation plan is recommended to prepare for the orderly and timely implementation of this FMP. This important step is intended to prompt decision-making, planning, scheduling, and budgeting at a more detailed level and to prepare for the design and construction phases of individual projects. An implementation plan will create a detailed long-range vision that is linked to design standards and objectives, funding strategies, and a multi-discipline study of the campus' utilities infrastructure systems that must be ready to support each new facility.

During the planning process, Crafton College Council discussed the recommended projects taking into account educational priorities, program growth, campus culture, and educational efficiencies. The following is a list of recommended projects.

New Construction and Renovation Projects

- › Performing Arts Center
- › Crafton Hall Renovation
- › East Valley Public Safety Training Center
- › West Complex Renovation
- › Student Support Building Renovation
- › New Gymnasium (New Construction), including Soccer Field and Outdoor Kinesiology Laboratories
- › Instructional Building (New Construction)
- › Teaching Pool (New Construction)
- › Central Complex 2 Renovation
- › Child Development Center Renovation

The campus-wide improvements are intended to be implemented incrementally, either in phases or as part of facilities projects.

Campus-wide Improvements

- › Enriched Environments for Student Activities
- › Campus-wide Learning Environment Upgrades
- › Campus-wide Vehicular Circulation & Parking Upgrades
- › Campus-wide Enriched Outdoor Environments
- › Campus-wide Security & Safety
- › Ancillary Logistics & Infrastructure